

### Click & clean LPJET14 Main station with integrated satellite.

Reference: 100.132

The Click & Clean LPJET series is designed especially for cleaning in high care areas which require a pressure increase and multiple hours of cleaning a day. These units are ideal for bakeries, butchers, super markets and high care food and beverage production areas.

With a single lever the operator can change between the different medias. Only compressed air, water and electric power are to be connected to the unit.

**Functions:**

- Foam cleaning
- Foam disinfection
- Clear water rinse

Click & clean LPJET units are standard equipped with:

- Stainless steel Grundfos booster pump AISI316 , with Bleu Flux "best efficiency " label and flow manager for automatic on/off switch.
- Stainless steel Maintenance free selector valve for water, chemicals and air.
- 2 separated chemical injectors with adjustable dosing ratio (0.15-15%) who makes it impossible to mix-up chemicals.
- Air regulator.
- Air manometer.
- Lockable stainless steel cabinet, with sloped top cover for optimal hygiene.
- Dry running protection.
- 1 x Stainless steel check valve on water supply.
- 2 x stainless steel check valves with extreme chemical resistant Kalrez seals on chemical suction.
- 1 x stainless steel check valve for air supply protection.
- 1 x Check valve with detector when first check valve is failing.
- 1 x bleu suction kit with filter and PVC pipe for foam cleaning chemical.
- 1 x yellow suction kit with filter and PVC pipe for disinfection chemical.
- Set Of dosing tips.
- Exit with water boosted pressure to supply other Click & clean satellites.

Mobile version is extra equipped with:

Ref. 100.132XM

- Click & clean main station with integrated satellite.  
See here above.
- Stainless steel heavy duty trolley
- 2 x big wheels on the back
- 2 x swivel wheels with brake in the front.
- Container holder for 2 x 25 liter cans.
- Stainless steel automatic spring driven hose reel.
- 20 meter 5 layer hose with textile reinforcements, Foodflex hose, FDA approved. Max. 50bar /70°C.
- Stainless steel isolated ball valve with integrated "3 in 1" triple click nozzle.

Wall mount version.



Mounting example.  
Hose reel and accessories not included.

Mobile version



#### Technical data Click & clean LPJET14

Water inlet connection:	1" BSP
Required inlet supply pressure:	2 - 6 bar
Required minimal inlet flow:	70 l/min.
Max. water temperature:	70°C
Max. outgoing pressure:	18 bar
Air inlet connection:	1/4" BSP
Required air supply pressure:	1 - 6 bar
Required air flow:	200 Lpm.
Max no of users simultaneously:	2
Chemical injectors (100% separated)	2
Chemical dosing ratio:	0.15 - 15%
Exit to hose reel:	½" BSP
Exit to second satellite:	½" BSP
Voltage (50hZ)	3 x 400V
Power:	3.2 kW
Cabinet dimensions (WxHxD):	600 x 600 x 250 mm

#### Connection and use LPJET14 Lain station with second Click & clean Decentral satellite.

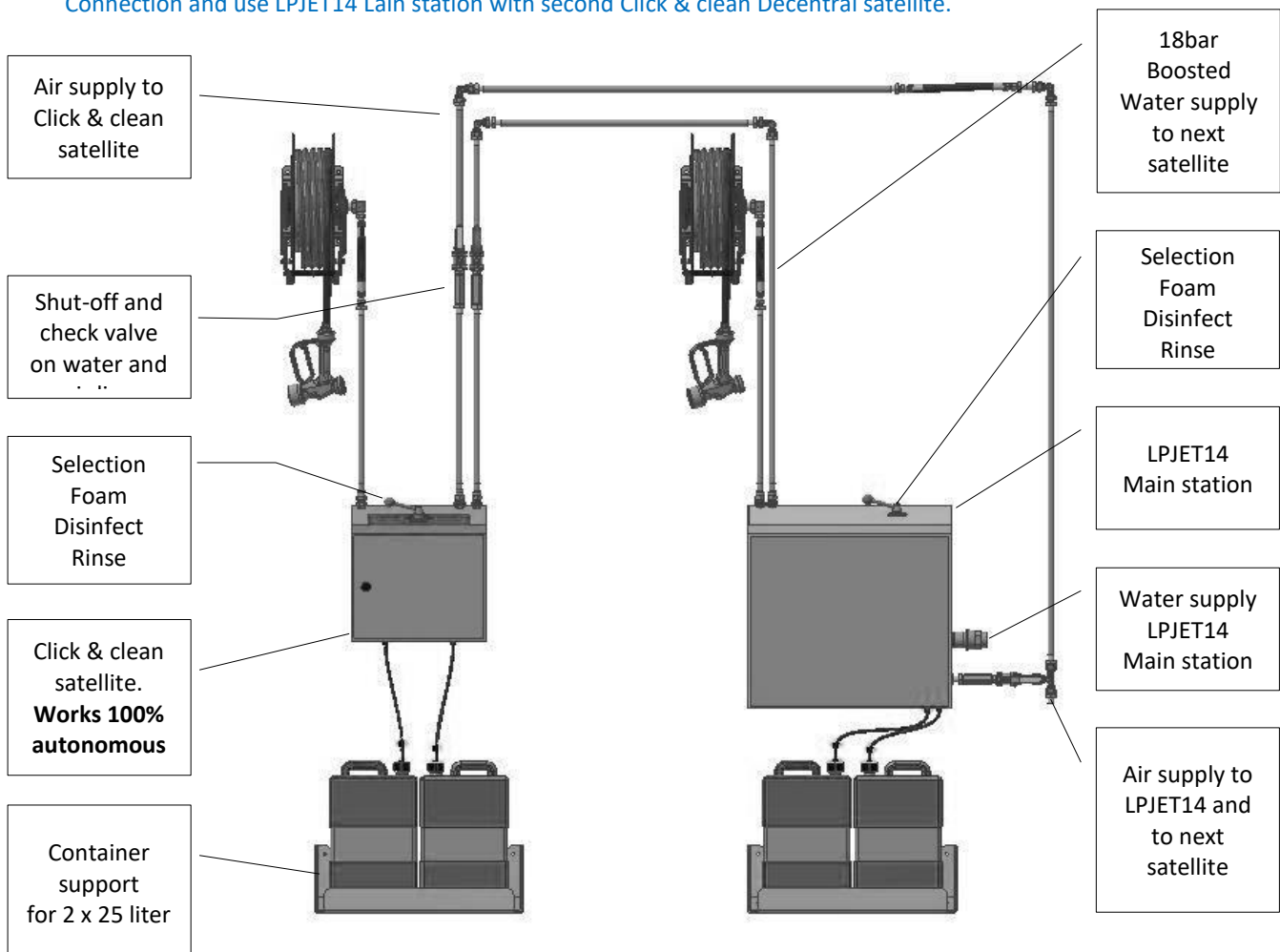

## Technical information

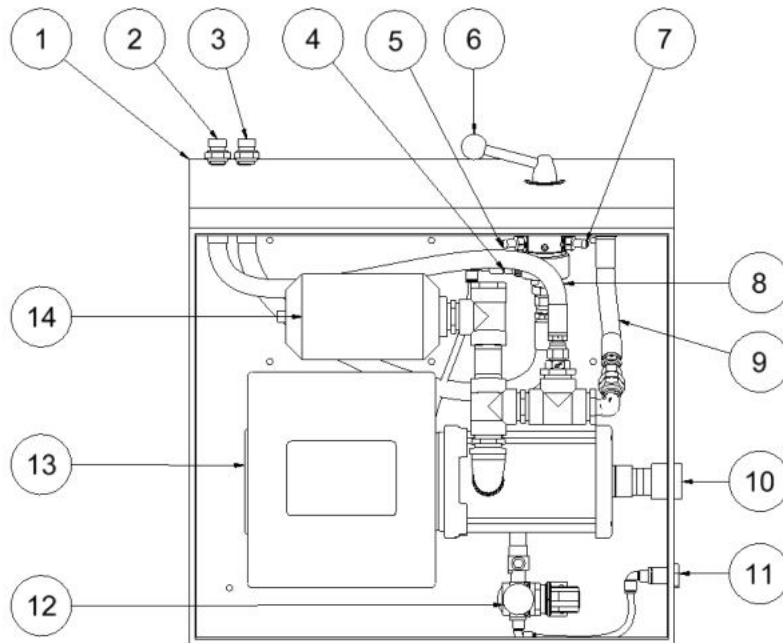

### Part description LPJET14

1	Stainless steel cabinet 600x600x250mm.
2	Adapter G1/2" M BSP to supply boosted water to next satellites.
3	Adapter G1/2" M BSP to hose reel.
4	Air inlet with check valve on Switch box.
5	Chemical (1) suction inlet with integrated check valve.
6	Position Switch handle (Foam, Rinse disinfect).
7	Chemical (2) suction inlet with integrated check valve.
8	Supply hose boosted water to exit adapter.
9	Supply hose boosted water to switch box.
10	Water inlet supply G1" F BSP.
11	Air inlet supply G1/4" F BSP.
12	Air regulator kit (dry/wet foam) with check valve and pressure release.
13	Stainless steel booster pump with frequency controller.
14	Accumulator