

CS

Před zapnutím sestavy zkontrolujte správné zapojení napájecích vodičů a zdroje!!

**INSTALACE:**

Montáž výrobku smí provádět pouze osoba způsobilá s příslušným oprávněním dle návodu a předpisů platných v místě instalace (zde podle vyhl. č. 50/78 Sb.)!

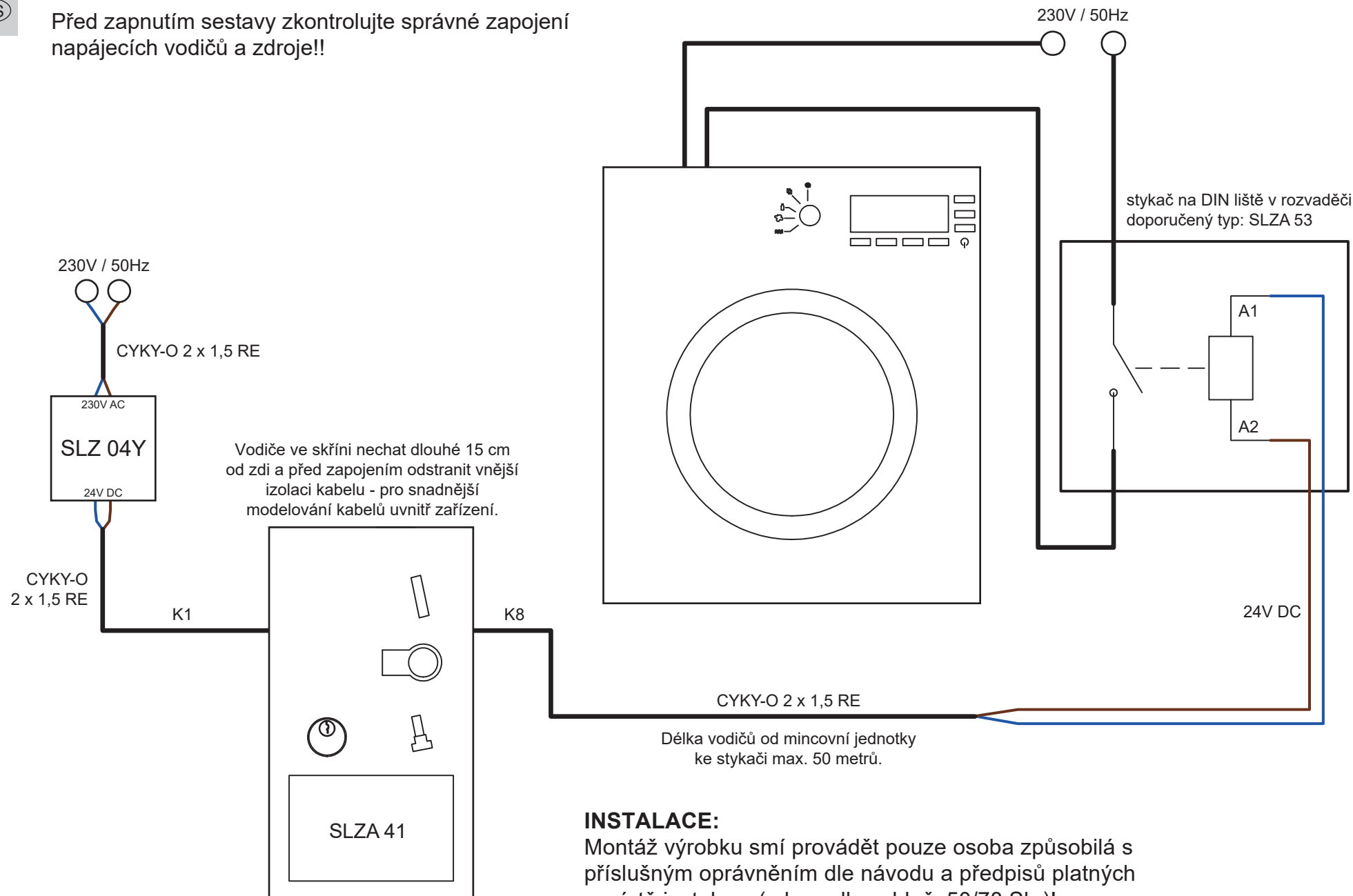
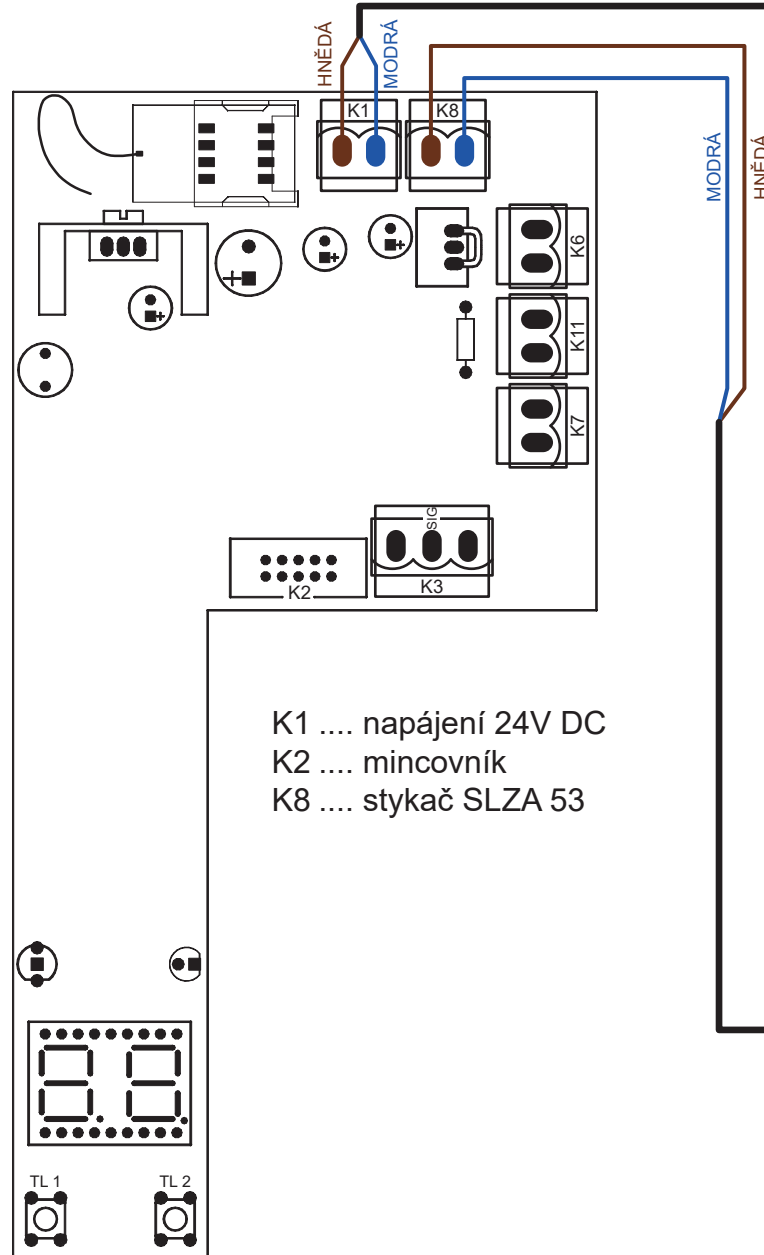

K1 napájení 24V DC
K2 mincovník
K8 stykač SLZA 53

Detail
DPS

K1 - hnědá, modrá

230V / 50Hz

24V DC

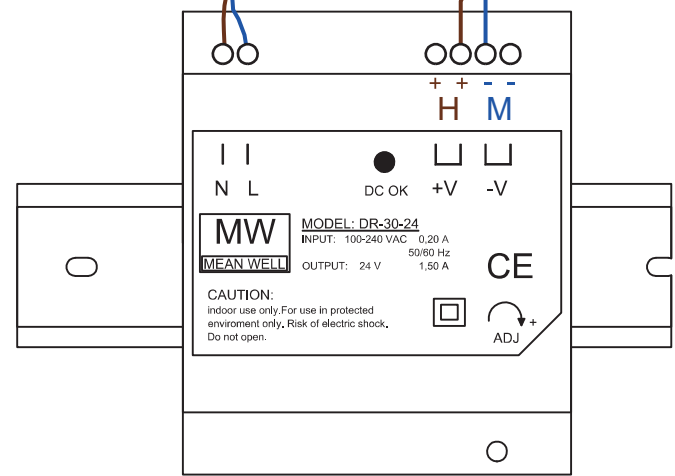

stykač na DIN liště v rozvaděči

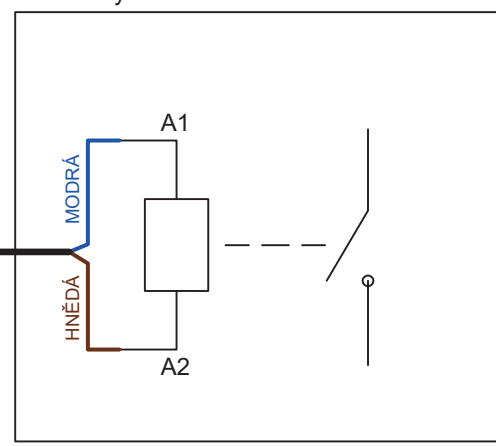

K8 - hnědá, modrá

Before switching on the module, check the correct connection of the power cables and the power supply!!

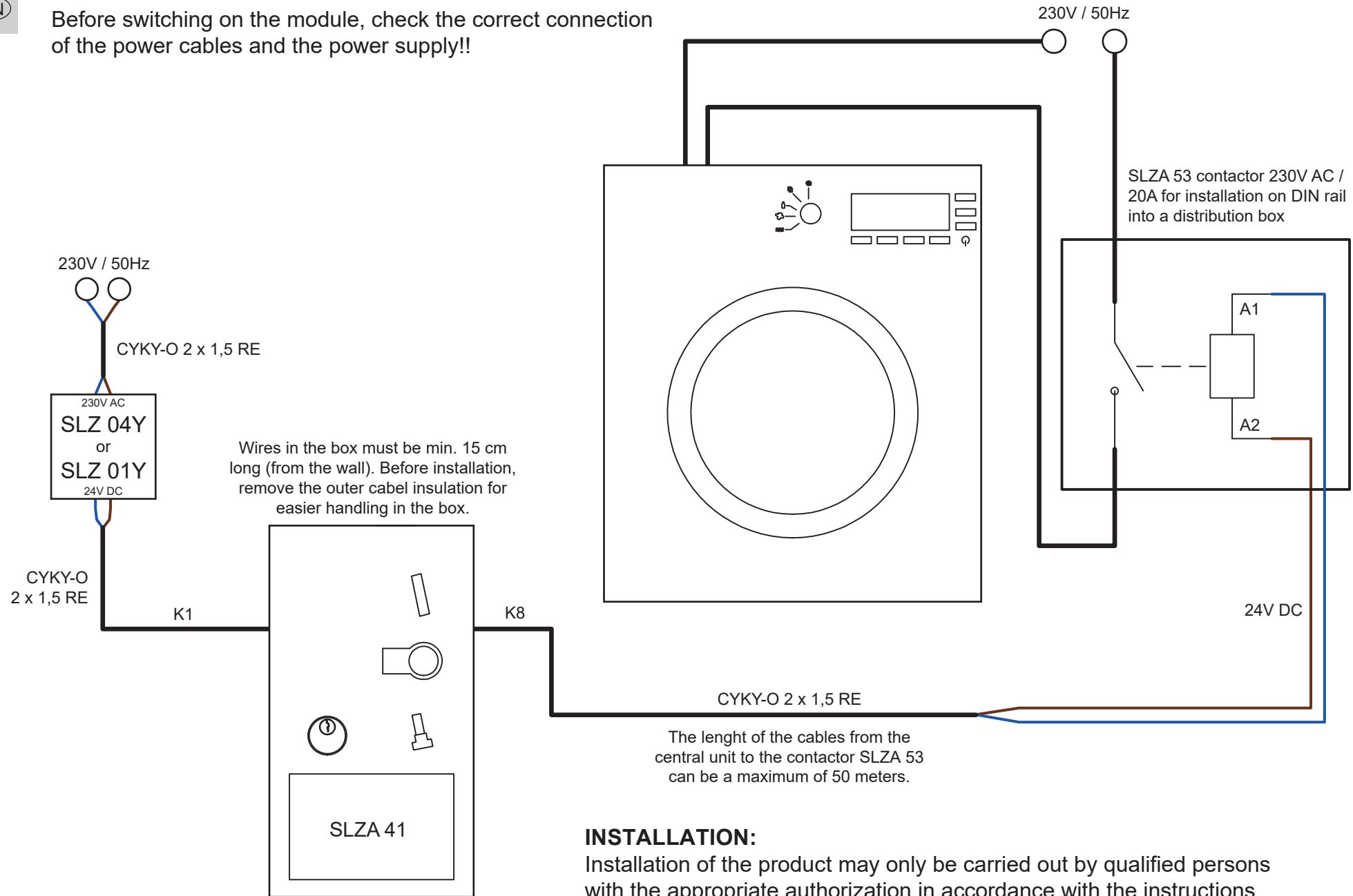

Wires in the box must be min. 15 cm long (from the wall). Before installation, remove the outer cable insulation for easier handling in the box.

The length of the cables from the central unit to the contactor SLZA 53 can be a maximum of 50 meters.

INSTALLATION:
Installation of the product may only be carried out by qualified persons with the appropriate authorization in accordance with the instructions and regulations at the installation site!

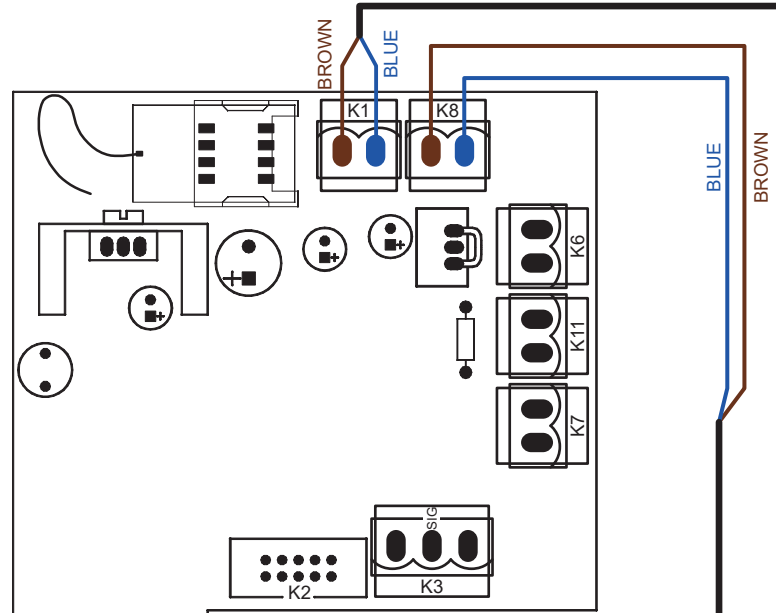

Detail of DPS

K1 power supply 24V DC
K2 coin unit
K8 contactor SLZA 53

K1 - blue, brown

230V / 50Hz

24V DC

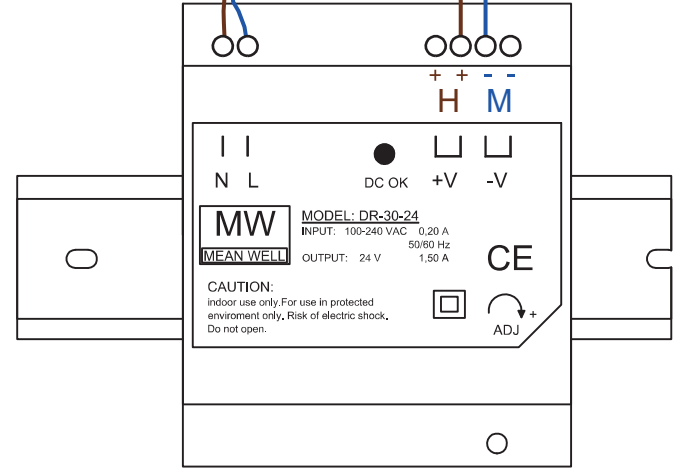

DIN rail (only for SLZ 04)

SLZA 53 contactor 230V AC / 20A on DIN-rail into a distribution box

K8 - blue, brown

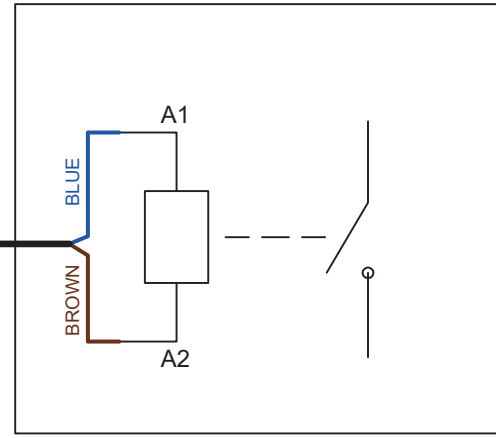

Überprüfen Sie vor dem Einschalten der Baugruppe den korrekten Anschluss der Stromkabel und der Stromversorgung!!

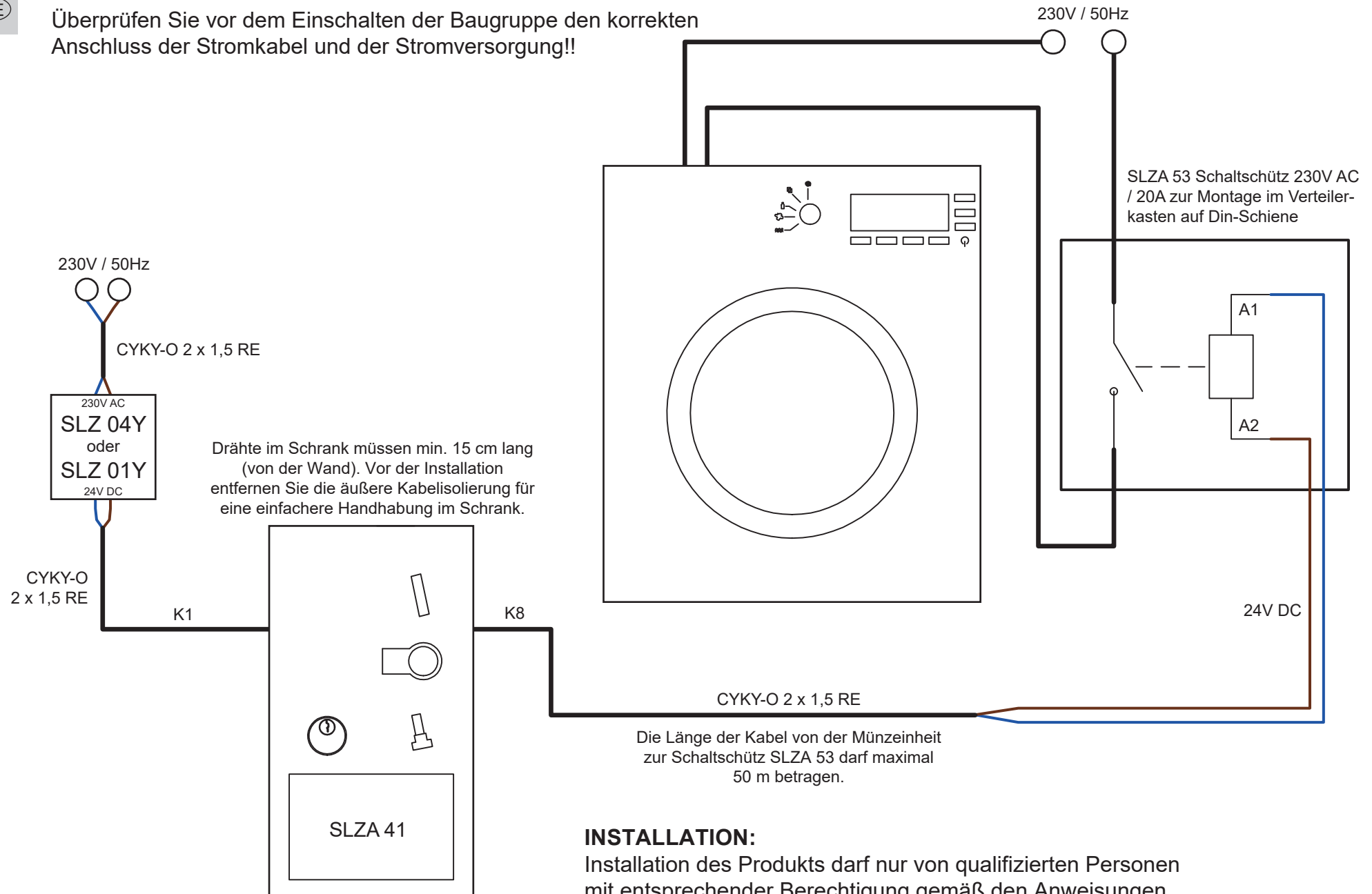

INSTALLATION:

Installation des Produkts darf nur von qualifizierten Personen mit entsprechender Berechtigung gemäß den Anweisungen und Vorschriften am Aufstellort durchgeführt werden!

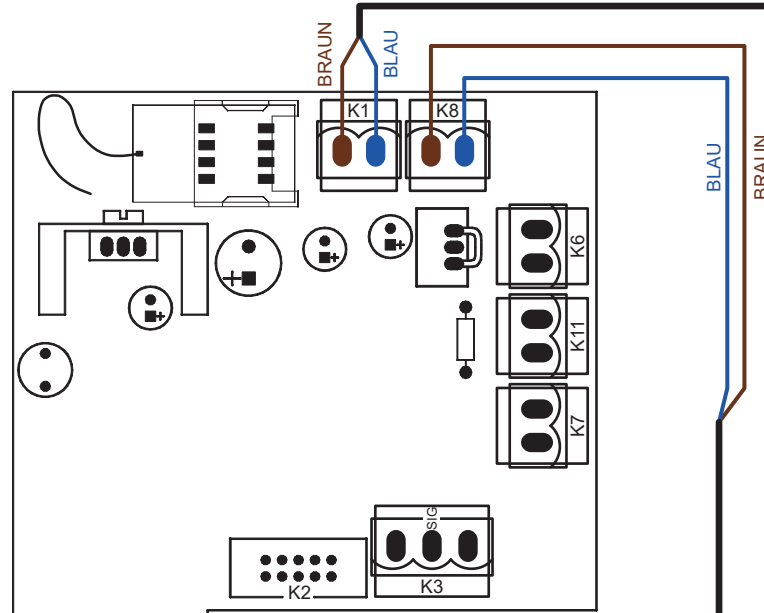

K1 Netzteil 24V DC
 K2 Münzeinheit
 K8 SLZA 53 Schaltschütz

DPS
 Detail

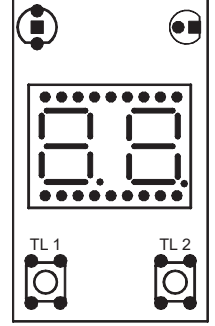

K1 - blau, braun

230V / 50Hz

24V DC

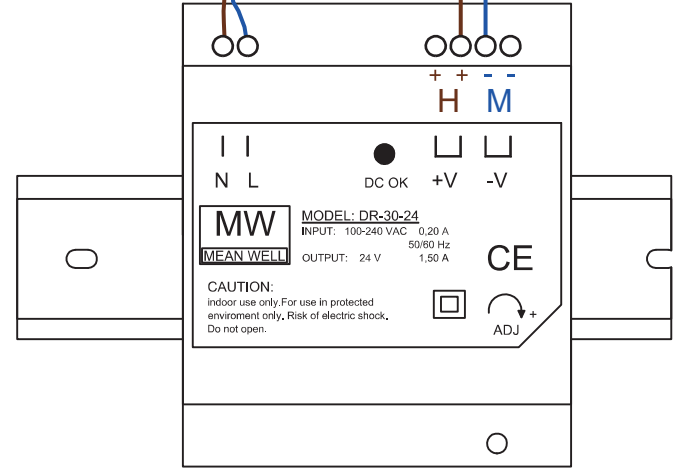

DIN-Schiene
 (nur für SLZ 04)

SLZA 53 Schaltschütz 230V AC / 20A
 auf DIN-Schiene im Verteilerkasten

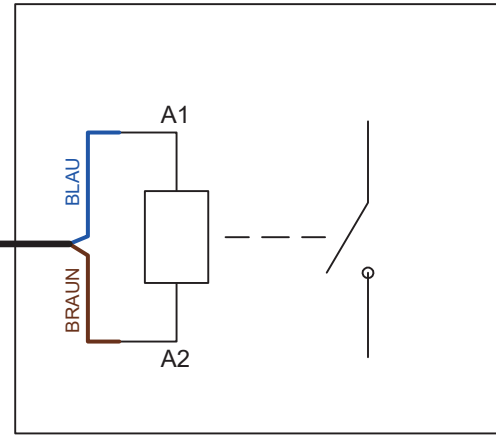

K8 - blau, braun